



Fixed Price £130,000

2 Bedroom Mews House for sale

Flat 39 The Malthouse, 167-169 Horninglow Street, Burton-on-Trent





Overview

Charming Two Bedroom Mews House. Available with NO UPWARD CHAIN, this stylish and contemporary TWO DOUBLE BEDROOM MEWS HOUSE presents an incredible opportunity! BOOK TO VIEW



Key Features

- CASH BUYERS ONLY
- Perfect First Time Buyer Property
- Historic Maltings Building
- Secure Gated Parking
- Open Plan Lounge Diner
- Two Double Bedrooms
- Spacious Contemporary Shower Room





Available with NO UPWARD CHAIN, this stylish and contemporary TWO DOUBLE BEDROOM MEWS HOUSE presents an incredible opportunity!

Boasting spacious open plan living, modern interiors, and allocated parking, this home is situated within walking distance of Burton Town Centre, offering easy access to shops, restaurants, and transport links. Whether you're looking to expand your rental portfolio or settle into a vibrant, well-connected area, this home ticks all the boxes!

To the ground floor there is a bright and airy lounge/diner with an open flow into the fully equipped kitchen fitted with stylish cabinets providing ample storage, and built-in appliances. A convenient downstairs W/C adds practicality.

Upstairs there are two generously sized bedrooms, offering cosy yet spacious retreats, both served by a contemporary shower room, finished with sleek fixtures and tiled splashbacks.

Outside there is ample parking for residents with space for one vehicle.

If you are looking for a stylish place to call home, this chic property could be the perfect fit for you! Book your viewing with EweMove today!



We are required by law to comply fully with The Money Laundering Regulations Act 2017 and as such need to complete AML ID verification and proof / source of funds checks on all buyers and, where relevant, cash donors once an offer is accepted on a property. We use Movebutler to complete the necessary checks, this is not a credit check and therefore will have no effect on your credit history. A non-refundable compliance fee of £30.00 inc. VAT per buyer / donor will be required to be paid in advance when an offer is agreed and prior to a sales memorandum being issued.

Floorplans

GROUND FLOOR

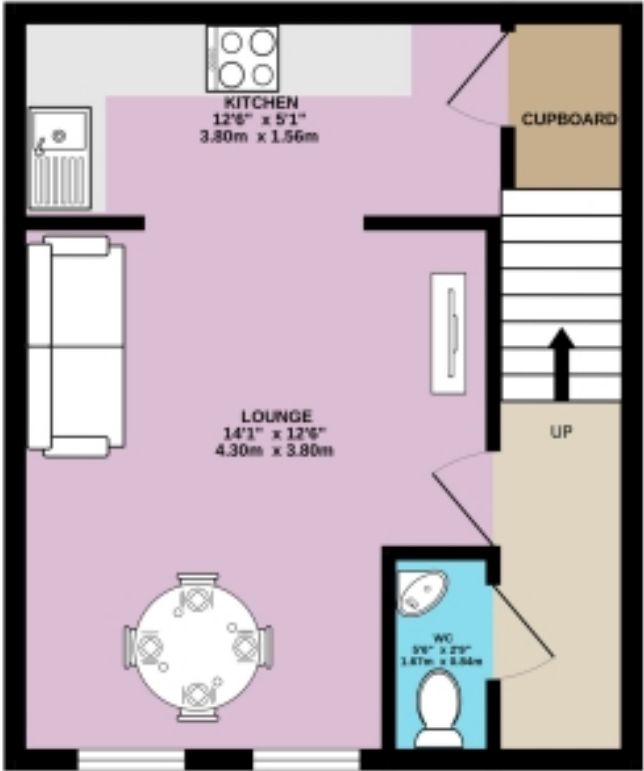

1ST FLOOR

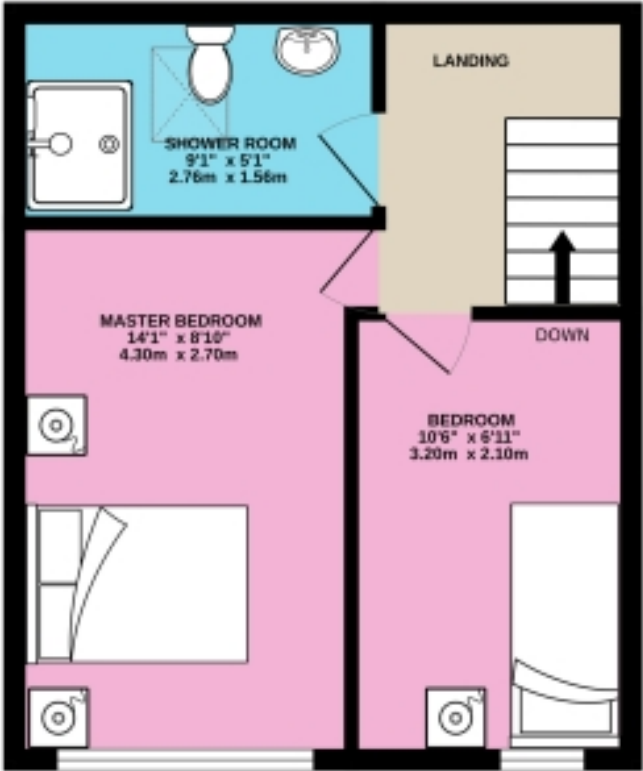

Whilst every attempt has been made to ensure the accuracy of the floorplan contained here, measurements of doors, windows, rooms and any other items are approximate and no responsibility is taken for any error, omission or mis-statement. This plan is for illustrative purposes only and should be used as such by any prospective purchaser. The services, systems and appliances shown have not been tested and no guarantee as to their operability or efficiency can be given.
Made with Metroplan 6/2025

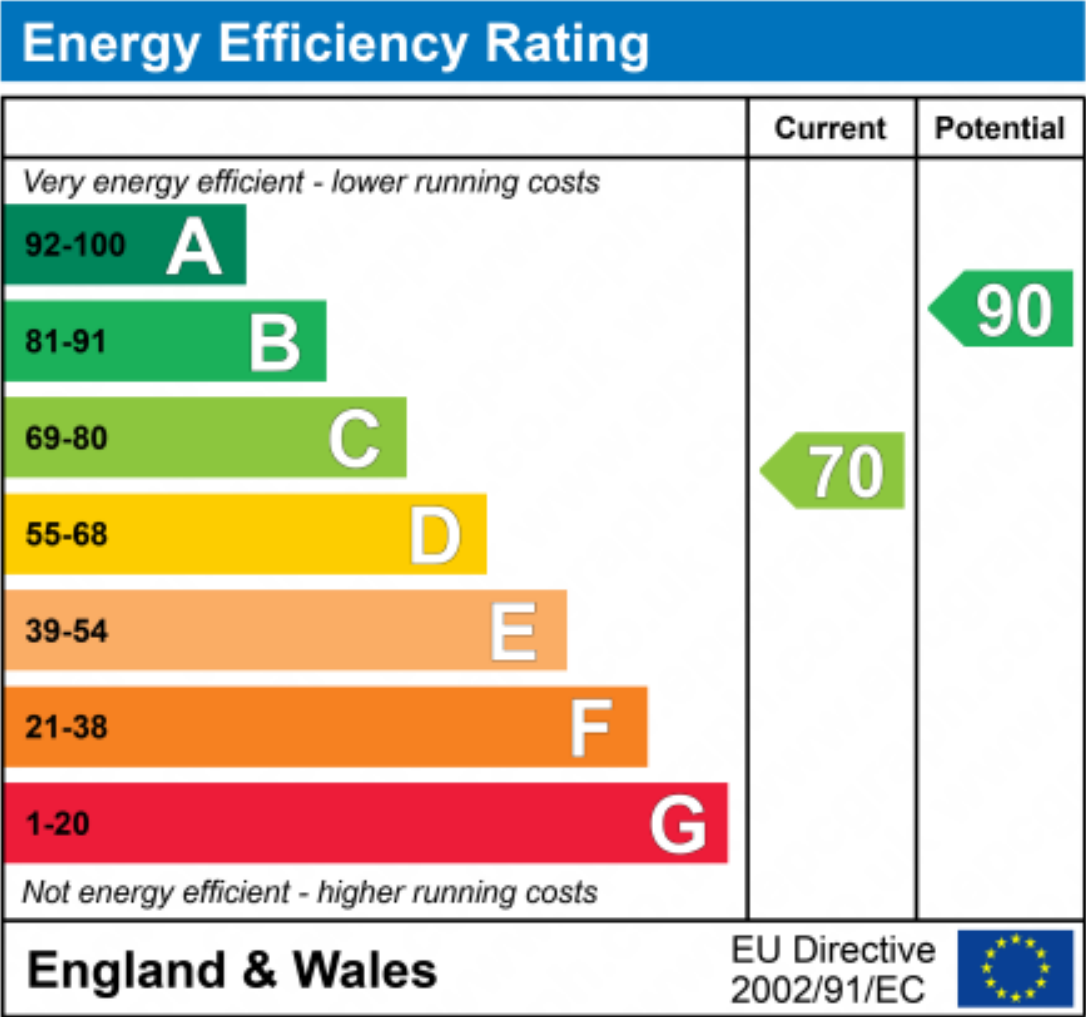



Marketed by EweMove Barton-under-Needwood

01283 247076 (24/7)
barton@ewemove.com

